

# ELECTRIC STORAGE WATER HEATERS NON-PRESSURE

Wall-mounted, electric

located under the consumption point -IN

located above the consumption point -UP

## BTO 5 UP, BTO 10 UP BTO 5 IN, BTO 10 IN

Type	BTO 5 UP	BTO 5 IN	BTO 10 UP	BTO 10 IN
A	390	390	500	500
B	264	-	398	-
C	-	138	-	122
D	256	256	350	350
E	213	213	265	265



BTO 5 UP  
BTO 5 IN

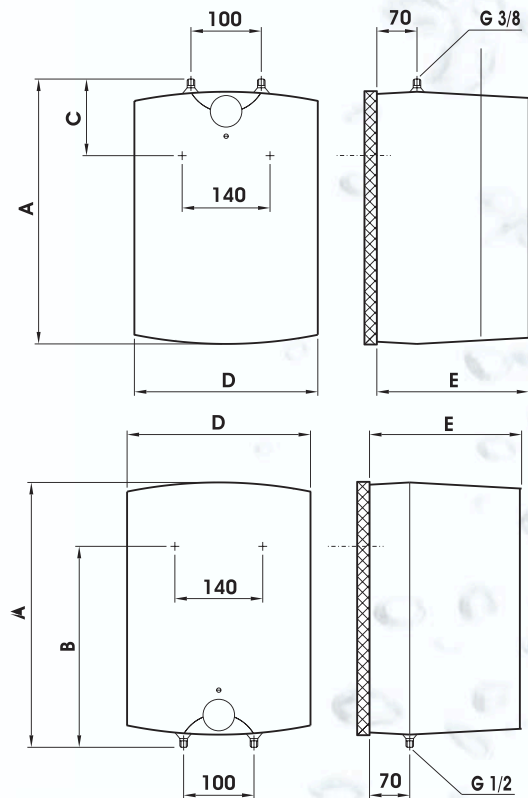
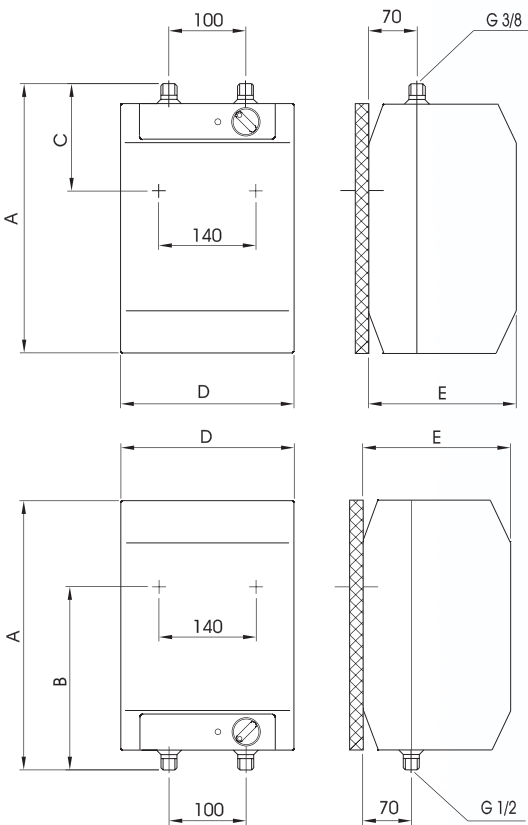

BTO 10 UP  
BTO 10 IN



Type	BTO 5 UP/IN	BTO 10 UP/IN
Volume (l)	5	10
Connected load (kW)	2	2
Nominal overpressure (MPa)	0	0
Heating period with ele. en. from 10 °C to 60 °C (min)	9	18
Height x width x depth (mm)	390x256x213	500x350x265
Weight (kg)	3.5	4
Tank	plastic	plastic
Electrical protection	IP 24	IP 24
Voltage (V/Hz)	1 PE-N 230/50	1 PE-N 230/50
Heat loss/energy efficiency class (kWh/24h)	0.32 / G	0.4 / G