

# ELECTRIC STORAGE WATER HEATERS PRESSURE

Wall-mounted, electric  
located under the consumption point -IN  
located above the consumption point -UP

**TO 10 UP, TO 15 UP**  
**TO 10 IN, TO 15 IN**

Type	TO 10 UP	TO 10 IN	TO 15 UP	TO 15 IN
A	500	500	500	500
B	398	-	398	-
C	-	122	-	122
D	350	350	350	350
E	265	265	310	310



TO 10 UP  
TO 15 UP

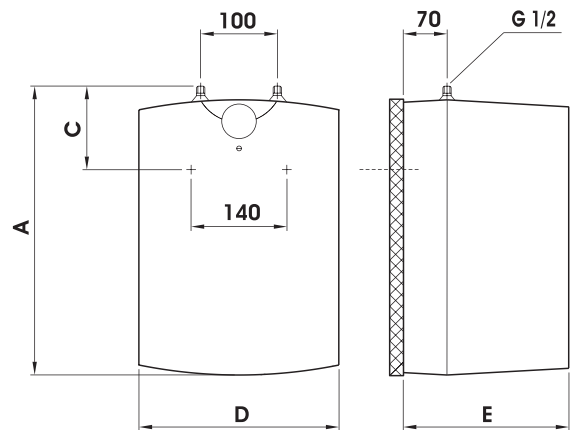
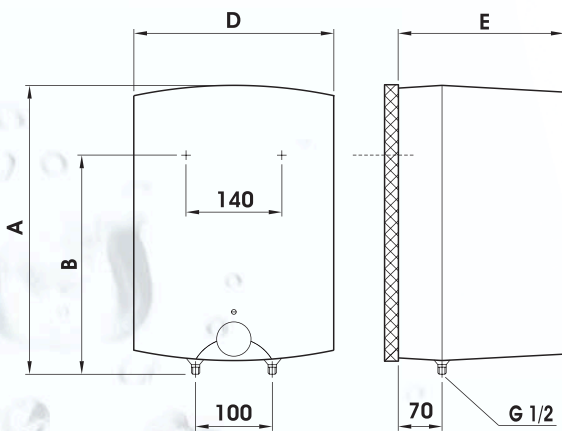

TO 10 IN  
TO 15 IN



Type	TO 10 UP/IN	TO 15 UP/IN
Volume (l)	10	15
Connected load (kW)	2	2
Nominal overpressure (MPa)	0.6	0.6
Heating period with ele. en. from 10 °C to 60 °C (min)	18	27
Height x width x depth (mm)	500x350x265	500x350x310
Weight (kg)	8	11
Tank	Enamelled steel	Enamelled steel
Electrical protection	IP 24	IP 24
Voltage (V/Hz)	1 PE-N 230/50	1 PE-N 230/50
Heat loss/energy efficiency class (kWh/24h)	0.33 / G	0.4 / G

# ELECTRIC STORAGE WATER HEATERS

## Wall-mounted, vertical

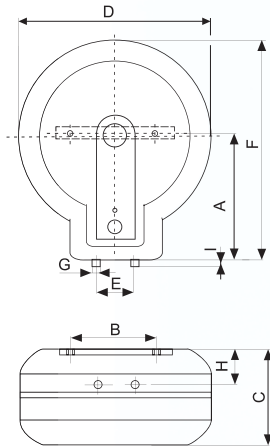

Type	TO 20
A	335
B	180
C	246
D	500
E	100
F	581
G	1/2"
H	98
I	16

## TO 20

The design of the TO 20 permits:

- Selection of the temperature of water being prepared between 7 and 77 °C
- Visual checking of the water temperature
- Prevention of overheating of the water
- Protection for the heater against freezing
- Visual indication that the water is being heated
- Positioning of the heater directly above a bath with a protection level IP 45
- Very low heat loss
- Connection of several off-take points for hot water (the heater is pressurised)
- Fast heating of water (from 10 °C to 60 °C in 31 minutes)

Type	TO 20
Volume (l)	20
Nominal overpressure (MPa)	0.6
Voltage (V/Hz)	1 PE-N 230/50
Heating period with ele. energy from 10 °C to 60 °C (min)	31
Weight (kg)	15
Tank	Enamelled steel
Electrical protection	IP 45
Connected load (kW)	2.2
Heat loss/energy efficiency class (kWh/24 h)	0.28/F