

## TO 20

- Capacity of 20 l
- Enamelled pressure vessel
- Electrical heating unit with power consumption of 2.2 kW
- The storage tank is of sufficient capacity for a shower or multiple washbasins



Types of storage tanks		TO 20
Capacity	[l]	20
Dimension (w × d × h)	[mm]	502 × 263 × 579
Weight of the empty water heater	[kg]	12
Insulation thickness	[mm]	20
Thermal conductivity of the insulation	[W·m <sup>-1</sup> ·K <sup>-1</sup> ]	0,022
Power consumption of the electrical heating unit	[W]	2200
Heating time from 10 °C to 60 °C	[h]	0,5
Electrical connection		1 PE-N 230V/50Hz
Recommended circuit breaker	[A]	16
Degree of protection		IP44
Max. working temperature / overpressure in tank	[ °C]/[bar]	90/6
Energy efficiency class		A
Annual consumption	[kWh·a <sup>-1</sup> ]	485

## TO

- Capacities of 5, 10 and 15 l
- Enamelled pressure vessel
- Electrical heating unit with power consumption of 2 kW
- Can be placed under (IN) or above (UP) the consumption point
- For one or more consumption points



Types of storage tanks		TO 5 UP	TO 5 IN	TO 10 UP	TO 10 IN	TO 15 UP	TO 15 IN
Capacity	[l]	6,2	6,6	9,8	9,9	14,8	14,9
Dimension (w × d × h)	[mm]	400 × 260 × 265		500 × 350 × 265		500 × 350 × 310	
Weight of the empty water heater	[kg]	6,8		8		11	
Insulation thickness	[mm]	28		30		30	
Thermal conductivity of the insulation	[W·m <sup>-1</sup> ·K <sup>-1</sup> ]			0,025			
Power consumption of the electrical heating unit	[W]			2000			
Heating time from 10 °C to 60 °C	[min]	11		20		29	
Electrical connection				1 PE-N 230V/50Hz			
Recommended circuit breaker	[A]			16			
Degree of protection				IP24			
Max. working temperature / overpressure in tank	[ °C]/[bar]			90/6			
Energy efficiency class				A			
Annual consumption	[kWh·a <sup>-1</sup> ]	514	525	508	524	510	523

## PTO

- With electrical heating units rated at 3.5 kW and 5 kW
- Use of a low-pressure water tap is required
- Only for one consumption point



Types of storage tanks		PTO 0733	PTO 1733
Dimension (w × d × h)	[mm]	204 × 175 × 80	204 × 175 × 80
Weight of the empty water heater	[kg]	1,6	1,6
Power consumption of the el. heating unit	[W]	3,5	5
Heating time from 10 °C to 60 °C	[h]	by means of through-flow	
Electrical connection		1 PE-N 230V/50Hz	
Recommended circuit breaker	[A]	20	25
Degree of protection		IP25	
Energy efficiency class		A	A
Annual consumption	[kWh·a <sup>-1</sup> ]	478	475

## TO 20

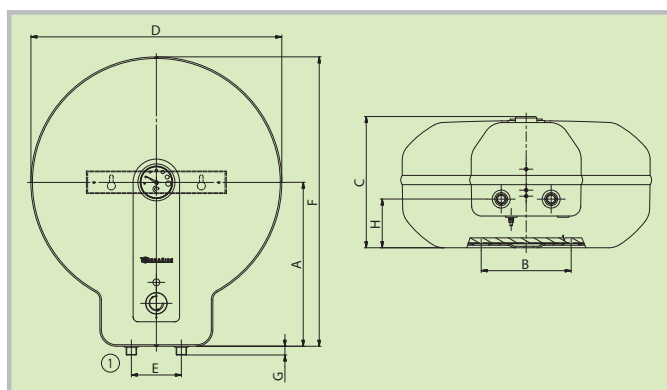

Dimensions [mm]	A	B	C	D	E	F	G	H
TO 20	328	180	263	502	100	579	18	98

## PTO

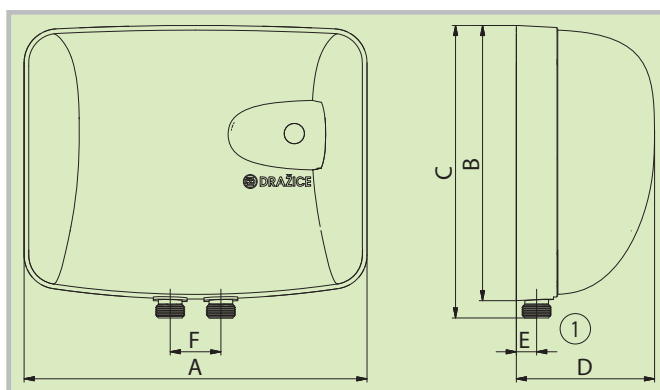

Dimensions [mm]	A	B	C	D	E	F
PTO 0733	204	161	175	80	13	30
PTO 1733	204	161	175	80	13	30

## TO

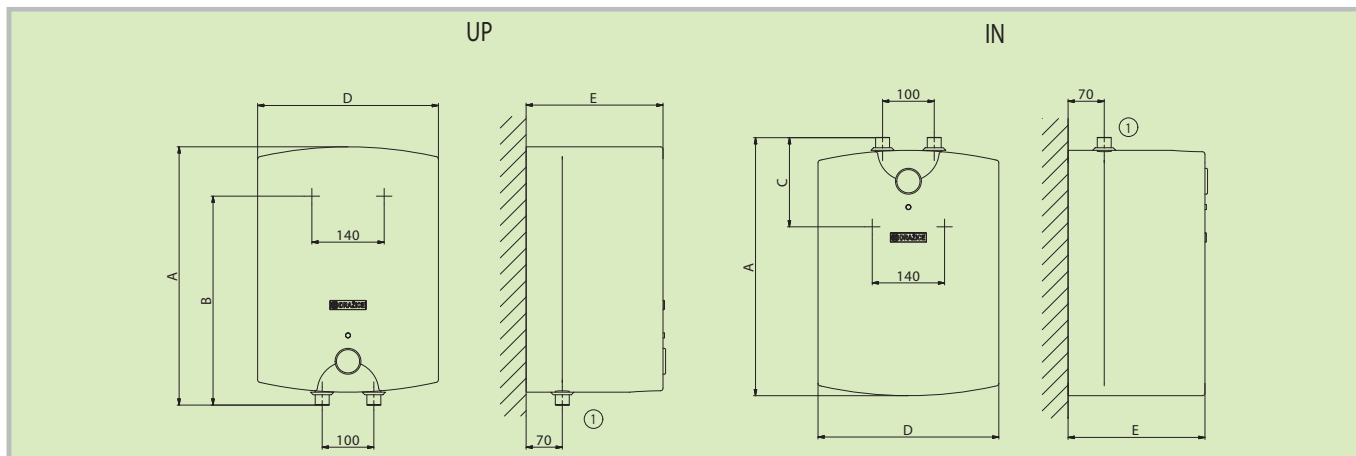

Dimensions [mm]	A	B	C	D	E
TO 5 UP	400	280	–	260	265
TO 5 IN	400	–	122	260	265
TO 10 UP	500	398	–	350	265
TO 10 IN	500	–	122	350	265
TO 15 UP	500	398	–	350	310
TO 15 IN	500	–	122	350	310

**BTO**

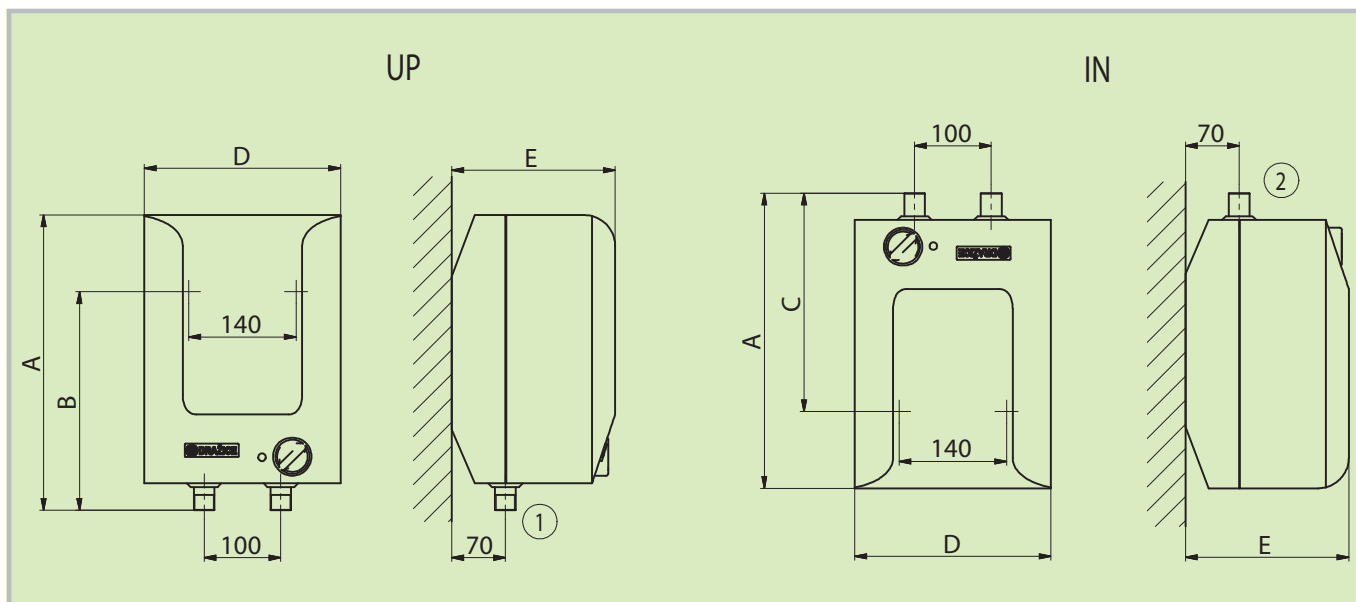

Dimensions [mm]	A	B	C	D	E
<b>BTO 5 UP</b>	390	264	–	256	213
<b>BTO 5 IN</b>	390	–	138	256	213
<b>BTO 10 UP</b>	500	398	–	350	265
<b>BTO 10 IN</b>	500	–	122	350	265

**CLOSE**

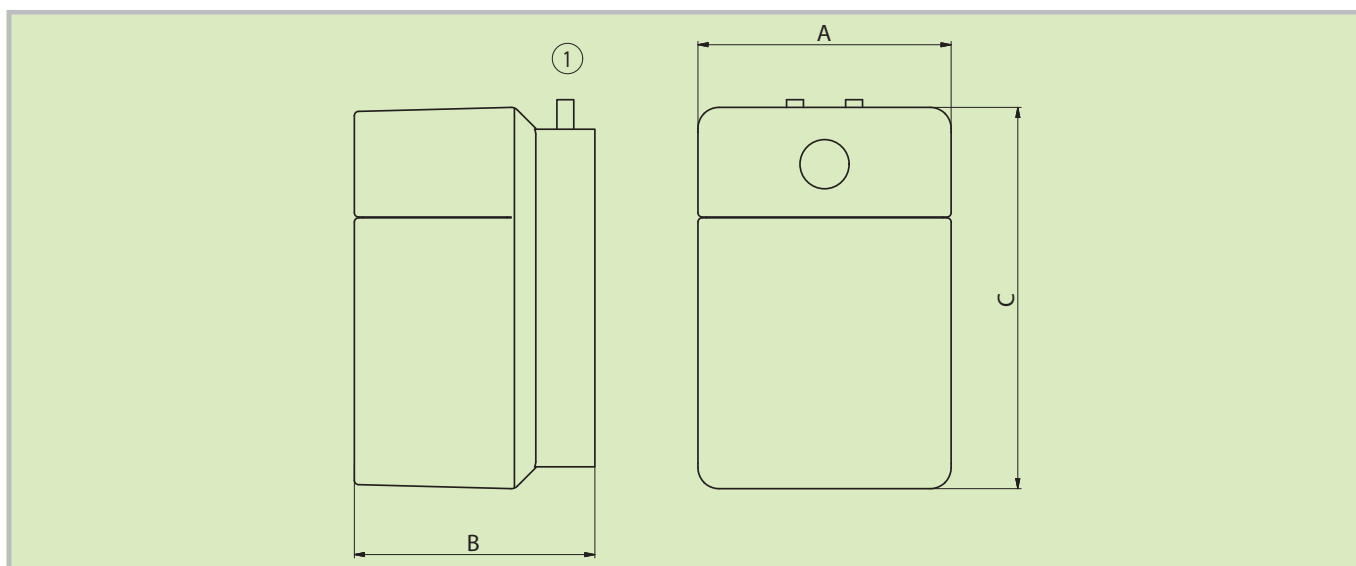

Dimensions [mm]	A	B	C
<b>CLOSE 10</b>	300	285	452
<b>CLOSE 15</b>	300	285	452

## BTO

- Capacities of 5 and 10 l
- Low-pressure plastic tank
- Use of a low-pressure water tap is required
- Can be placed under (IN) or above (UP) the consumption point
- Only for one consumption point



Types of storage tanks		BTO 5 UP	BTO 5 IN	BTO 10 UP	BTO 10 IN
Capacity	[l]	5,5	5,7	9,8	9,9
Dimension (w × d × h)	[mm]	390 × 256 × 213		500 × 350 × 265	
Weight of the empty water heater	[kg]	3,5		4	
Insulation thickness	[mm]	31		35	
Thermal conductivity of the insulation	[W·m <sup>-1</sup> ·K <sup>-1</sup> ]			0,045	
Power consumption of the el. heating unit	[W]			2000	
Heating time from 10 °C to 60 °C	[min]	10		20	
Electrical connection		1 PE-N 230V/50Hz			
Recommended circuit breaker	[A]	16			
Degree of protection		IP24			
Energy efficiency class		A	A	A	A
Annual consumption	[kWh·a <sup>-1</sup> ]	525	527	523	525

## CLOSE

- Capacities of 10 and 15 l
- Copper pressure vessel
- Electrical heating unit with power consumption of 2.2 kW
- Can be placed under (IN) or above (UP) the consumption point



Types of storage tanks		CLOSE 10 UP	CLOSE 10 IN	CLOSE 15 UP	CLOSE 15 IN
Capacity	[l]	10,8		15,8	
Dimension (w × d × h)	[mm]	452 × 300 × 285		452 × 300 × 285	
Weight of the empty water heater	[kg]	6,5		7,5	
Power consumption of the el. heating unit	[W]			2200	
Heating time from 10 °C to 60 °C	[min]	20		25	
Electrical connection		1 PE-N 230V/50Hz			
Recommended circuit breaker	[A]	16			
Degree of protection		IP44			
Energy efficiency class		A	A	A	A
Annual consumption	[kWh·a <sup>-1</sup> ]	512	515	539	529

Contact: